

rec by studio TK
product information

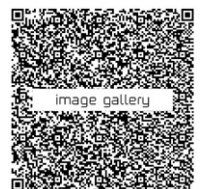

For more inspiration

teknion

rec by studio TK

product details

product description

Designed by Christophe Pillet, the Rec Table takes its cue from the raw, rectangular worktables of the industrial age, reinterpreted for contemporary spaces that value clean lines and purposeful design. Rec offers a high working posture that suits active professionals and creative thinkers, including those who shift between seated and standing work or prefer more casual, movement-based collaboration.

It fits naturally into open-plan or perimeter layouts, supporting a range of scenarios from personal touchdown to quick team huddles and longer, project-based sessions. The collection is available in three heights to suit varied needs. Two top styles—single or split—are offered in multiple sizes, with surface finishes in linoleum, laminate, or veneer. Base options include a variety of styles, finished in powder-coated metal.

fabrics & finishes

Table Top Finishes

Laminate, Veneer, Linoleum

Leg Finishes

Powder Coated Finishes

collection



For more information

teknion

Single top workshop table

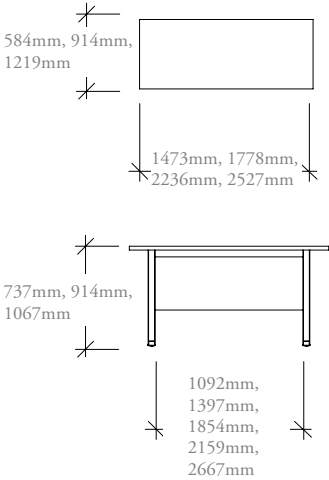

Ganged single top workshop tables

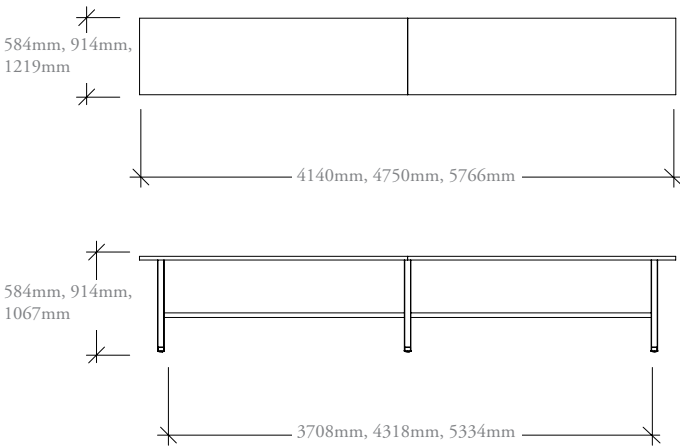

Split top workshop table

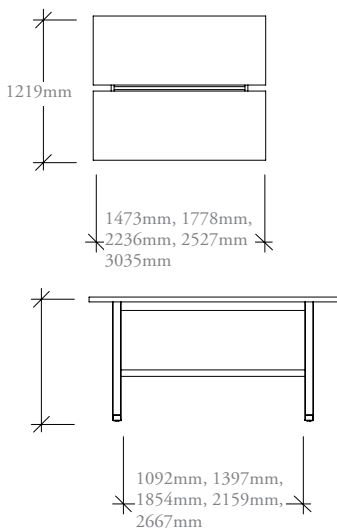

Ganged split top workshop tables

